

High ESP Duct

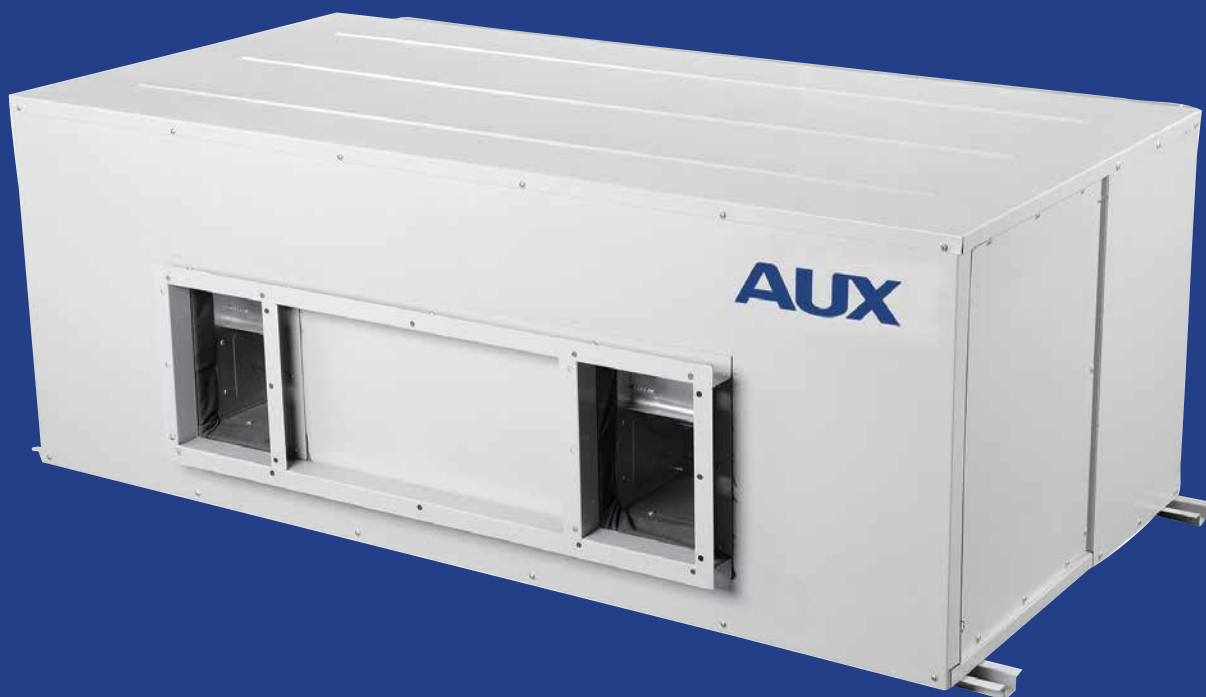

AUX
AIR CONDITIONER



High ESP Duct

Specifications

	ARVHD-H112/4R1A	ARVHD-H125/4R1A	ARVHD-H140/4R1A	ARVHD-H150/4R1A	ARVHD-H220/4R1A	ARVHD-H280/4R1A
Power Supply V~, Hz, Ph	220~240, 50, 1	220~240, 50, 1	220~240, 50, 1	220~240, 50, 1	220~240, 50, 1	220~240, 50, 1
Cooling Capacity (kw)	11.2	12.5	14.0	15.0	22.4	28.0
Heating Capacity (Kw)	12.8	13.3	15.0	16.0	25.0	31.5
Brand	Sanxiang	Sanxiang	Sanxiang	Sanxiang	Yilida	Yilida
Output Power (W)	200	200	200	200	380	380
Capacitor (uF)	10	10	10	10	15	15
Speed (Hi/Mi/Lo) (r/min)	1230/1000/800	1230/1000/800	1230/1000/800	1230/1000/800	1290/1200/1140	1290/1200/1140
Indoor Air Flow (Hi/Mi/Lo) (m3/h)	2000/1600/1400	2000/1600/1400	2000/1600/1400	2000/1600/1400	4000/3200/2600	4000/3200/2600
Noise Level(Hi/Mi/Lo) (dB(A))	60/57/51	60/57/51	60/57/51	60/57/51	55/54/53	55/54/53
External Static Pressure (Pa)	196	196	196	196	220	220
Net Dimension (WxDxH) (mm)	1200x719x380	1200x719x380	1200x719x380	1200x719x380	1350x700x460	1350x700x460
Net Weight (kg)	56	56	56	56	91	91
Piping - Liquid Side (mm)	9.52(3/8)	9.52(3/8)	9.52(3/8)	9.52(3/8)	12.7 (1/2)	12.7 (1/2)
Piping - Gas Side (mm)	19.05(3/4)	19.05(3/4)	19.05(3/4)	19.05(3/4)	22.2(7/8)	22.2(7/8)
Water Pipe - Drainage (mm)	R3/4in(DN20)	R3/4in(DN20)	R3/4in(DN20)	R3/4in(DN20)	DN25	DN25
Operation Temperature Range (°C)	16~32	16~32	16~32	16~32	16~32	16~32
Ambient Temperature Range (Cooling/Heating) (°C)	-5~-52/-20~24	-5~-52/-20~24	-5~-52/-20~24	-5~-52/-20~24	-5~-52/-20~24	-5~-52/-20~24
Application Area (m2)	50~75	50~90	60~100	65~110	50~75	50~90



XK-05
Wired Controller
(Standard)



Type K
Controller
(Optional)



Central Controller
(Optional)



WiFi
Controller
(Optional)

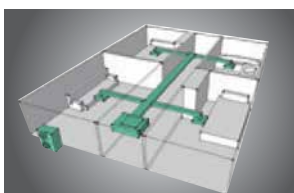

Long Distance Air Supply

High ESP makes the air supply distance up to 50m.

